

SCHOOL DISTRICT OF MANAWA



2018 Referendum

Vote November 6, 2018

QUESTION NUMBER I

Shall the School District of Manawa, Waupaca County, Wisconsin be authorized to issue pursuant to Chapter 67 of the Wisconsin Statutes, general obligation bonds in an amount not to exceed \$12,000,000 for the public purpose of paying the cost of a school building improvement program consisting of: construction of additions at the Jr./Sr. High School; District-wide renovations, capital maintenance, building infrastructure, safety and site improvements; and acquisition of related furnishings, fixtures and equipment?

YES

NO

QUESTION NUMBER II

Shall the School District of Manawa, Waupaca County, Wisconsin be authorized to exceed the revenue limit specified in Section 121.91, Wisconsin Statutes, by \$365,000 for the [2019-2020] school year, for non-recurring purposes consisting of demolishing the vacant former elementary school building and returning the site to green space?

YES

NO

ELEMENTARY SCHOOL

The elementary school and site will be updated with remodeling and renovations

- Remodel early childhood and 4-year-old kindergarten classrooms with toilet rooms and new casework designed for the needs of the primary-aged child
- Reconfigure traffic flow to create dedicated bus and parent pick-up/drop-off areas
- Renovate the existing playground
- Replace roofing sections, the fire alarm system, doors and flooring
- Repair/replace remaining outdated clocks, electrical, plumbing and heating building system components
- ADA compliance projects

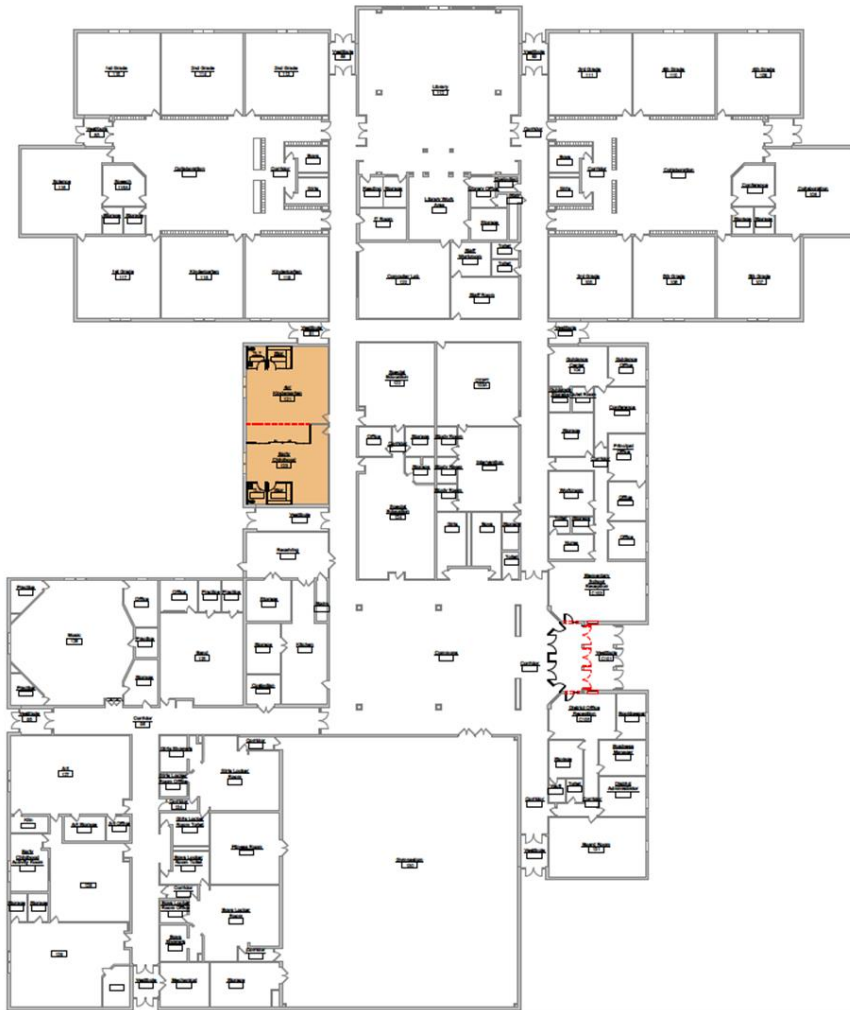

MANAWA ELEMENTARY SCHOOL -
FIRST FLOOR PLAN



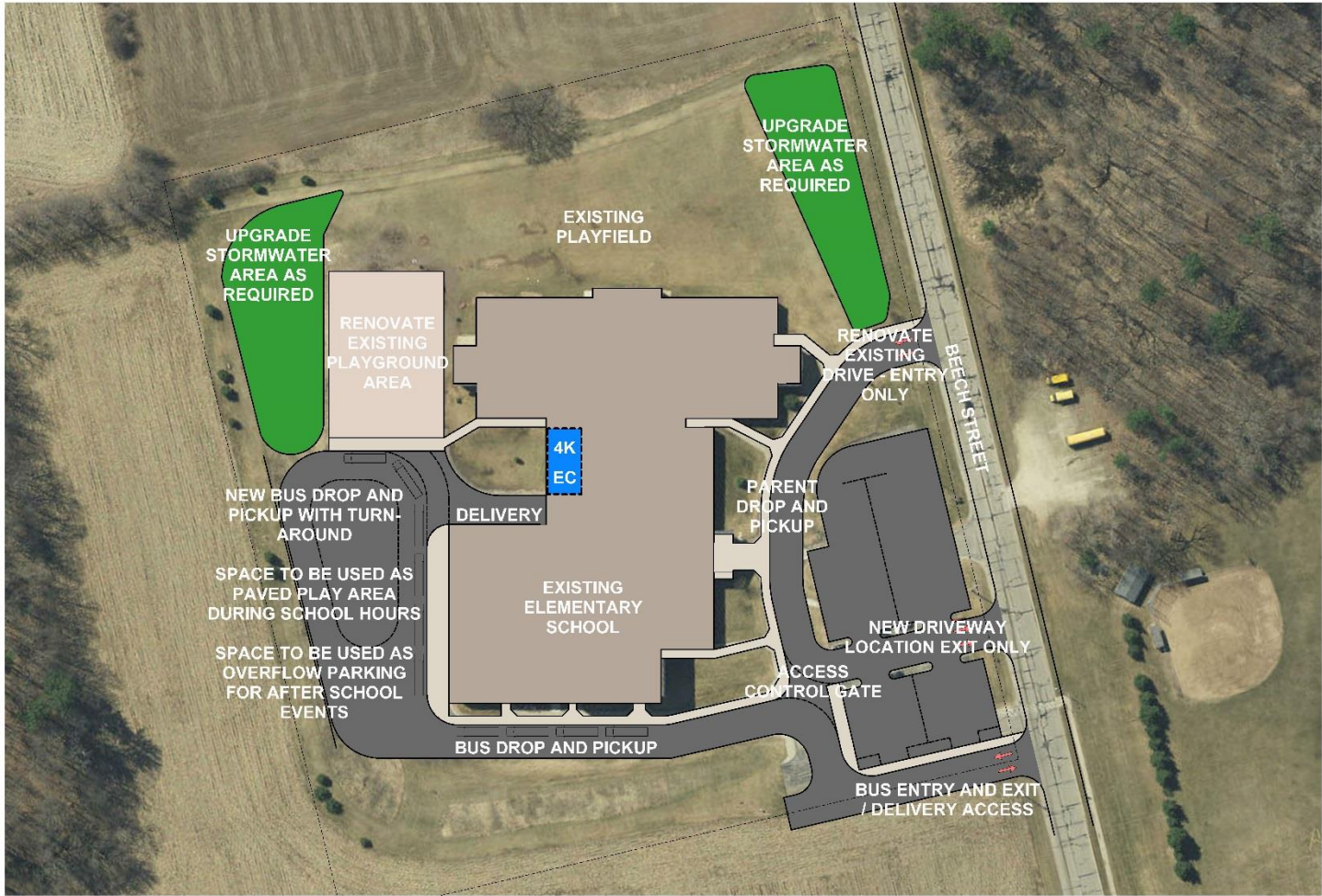

1 ELEMENTARY SCHOOL SITE FLOOR PLAN

LITTLE WOLF JR./SR. HIGH SCHOOL

The Jr./Sr. high school will be updated with additions, remodeling and renovations

- Reconfigure to create a true middle school, serving students in 6th – 8th grade
- Renovate special education, science and general education classrooms to update infrastructure, finishes, amenities and science lab equipment.
- Renovate the agriculture and technical education (shop) areas to update infrastructure, finishes, equipment and create collaborative space options.
- Renovate the fine arts area (band and stage) by filling in the “pit” of the band room and updating stage equipment, stage lighting and sound system.
- Redesign an ADA accessible main entrance including new construction to relocate administration and provide better control over visitor access.

LITTLE WOLF JR./SR. HIGH SCHOOL

- Renovate the family and consumer education lab by completely updating finishes, infrastructure, casework and appliances.
- Add a lower level school and community fitness and weight room with community access from the west parking lot. Remodel existing locker room space to add changing rooms and training room accessible from outside the locker rooms.
- New elevator for access between levels and event entrance
- Replace roofing sections, the fire alarm system, security system, doors, ceiling tile and flooring
- Repair/replace remaining outdated clocks, electrical, plumbing and heating building system components
- ADA compliance projects

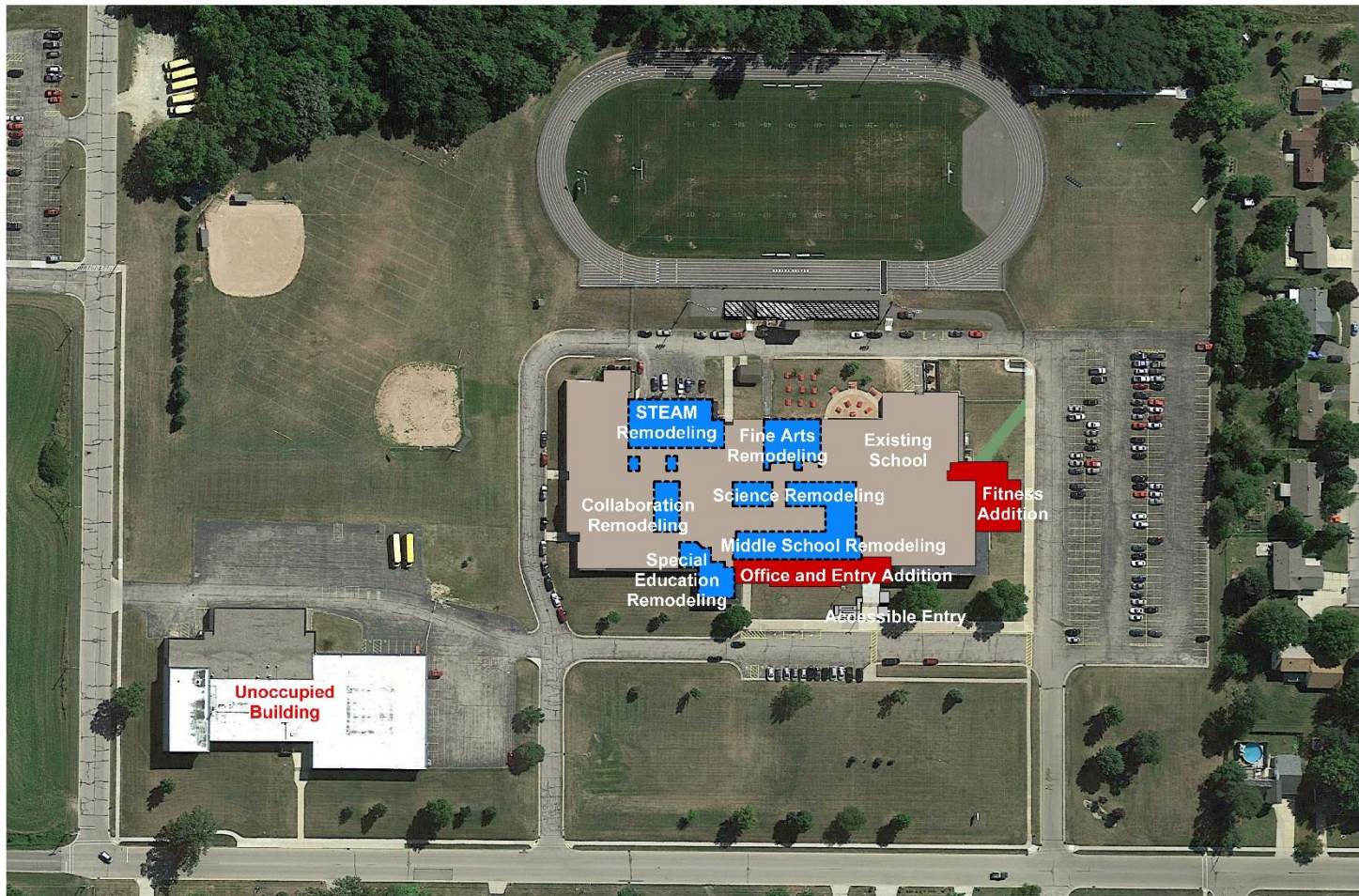

MIDDLE SCHOOL AND HIGH SCHOOL
SITE FLOOR PLAN



QUESTIONS?
Community Meeting
Wednesday, September 12, 2018
Little Wolf Jr./Sr. High School Commons
6:30 p.m.

For more information please visit:
www.manawaschools.org